



## Anti-Touch High-Voltage Electric Fence Energizer

- ★ Touch fence, short circuit, break, tamper detection & communication failure
- ★ Reverse polarity differential voltage output technology
- ★ Standard 12.6V/440mAh lithium battery
- ★ Flyback pulse testing anti-cut alarm technology
- ★ No level adjustment for output pulse, Long-distance equipment, auto switch function
- ★ RS 485 bus control, keypad, computer, network & multiple long distance management

### TECHNICAL SPECIFICATIONS

VOLTAGE FENCE ENERGIZER	
Output High Voltage	8KV ~ 14KV (continuous adjustable)
Output Low Voltage	600v-1.5kv (continuous adjustable)
Pulse Current	<500mA
Pulse Duration	≤0.1
Pulse Interval	1s ~ 1.2s
Zones	Single / Double
Single Pulse Output Maximum Power	2.5mC
Single Pulse Output Max. Energy	≤5.0J
Alarm Detection	Touch fence, short circuit, break, tamper detection & communication failure
LCD Display	Indicating the working state and the voltage of on every wire of fence
Auto Switch Function for Output Pulse	Yes
INTERFACE	
Alarm	Have DC12V NO/NC output port to linkage other security system to improve detection efficiency
NETWORK	
Ethernet	RJ-45 (10/100Base-T)
Protocol	TCP/IP/POE
Control Center Management Software	Yes
Communication Interface	RS-485
ELECTRICAL	
Power Supply	AC85V ~ 265V 50Hz
Power Consumption	≤15W
Battery	12.6V/440mAh lithium battery (Optional)
Battery Backup	Work about 16 Hours in case of Power Failure
ENVIRONMENTAL	
Operating Conditions	-25° C ~ +55° C
Storage Conditions	-30° C ~ +60° C
Ingress Protection	IP65
CONSTRUCTION	
Casing	ABS Plastic
Dimensions	313.73mm × 241.3mm × 63.5mm (12.35"×9.5"×2.5")
Net Weight	1.12Kg (2.47lb)
Gross Weight	1.52Kg (3.35lb)
CERTIFICATIONS BY NABL LAB	
Safety Protection- IEC/EN 60950/ IS 13252 Part 1 : 2010, IS 302-2- 76 : 1999 / IEC 60 335-2-76, CE, FCC, ISO 9001:2015, ROHS.	

\*Design and specifications are subject to change without notice

A high voltage electric fence system is a special product for high security military base, which will automatically process AC 220V mains supply through the fence host at a certain frequency intermittent output, and will change AC 220V mains supply to AC 4500V alternating pulse voltage which according with the standard electric shock strength through the built-in pressure boosting device of host, and will load a high voltage on the front wall of ACSR of mandatory type places to block the person who want to climb over the wall at a high-pressure blow.

AC 220V Mains supply is transported to each host of electric fence system through power cable after the voltage stabilizing by UPS sine (standby power, itself has the voltage stabilizing function), and each electric fence host will arm or disarm according to the command. When electric fence host is set to arm state, it will load the detection pulse on the front high-tension porcelain insulator of ACSR to detect the front situation. If someone attempt to climb over the fence, and touch the fence, the host will inspect the electric current change, and will compare to the precise data analysis, eliminate the false positives trigger alarm, at the same time it will output hit pulse until it is confirm electric current change. The electric fence host will feedback the alarm signal to control site through RS-485/TCP/IP/POE line to inform the on duty personnel from which zone the alarm has trigger, effective improved the strength of duty.

Each zone has alarm output interface, when an alarm triggers the siren will sent out a high decibel sound immediately to the person monitoring in the control center.



**System Diagram**

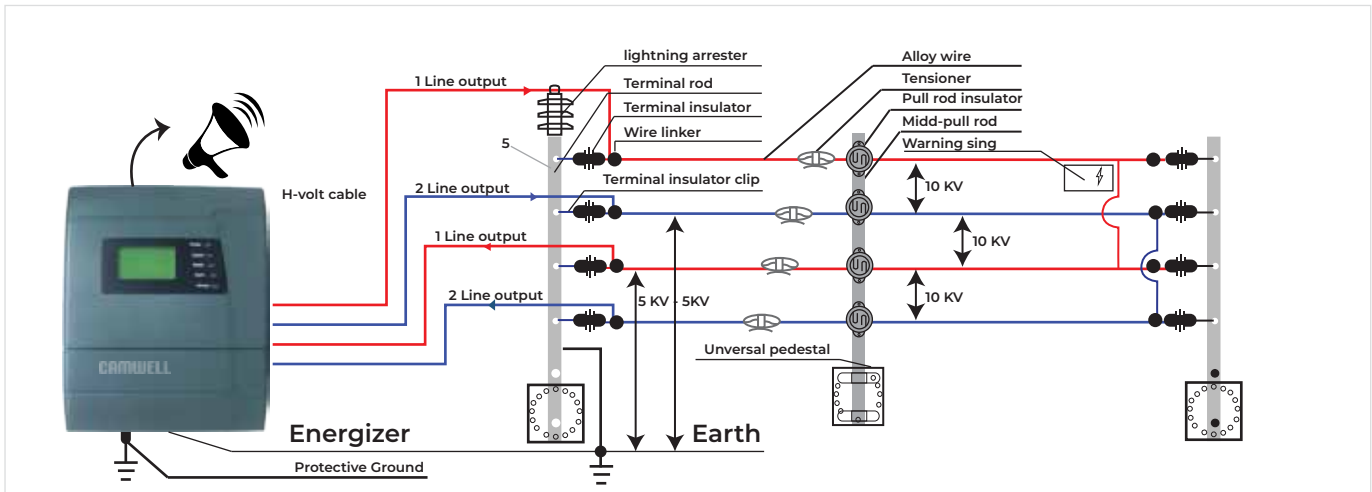

**Solution**

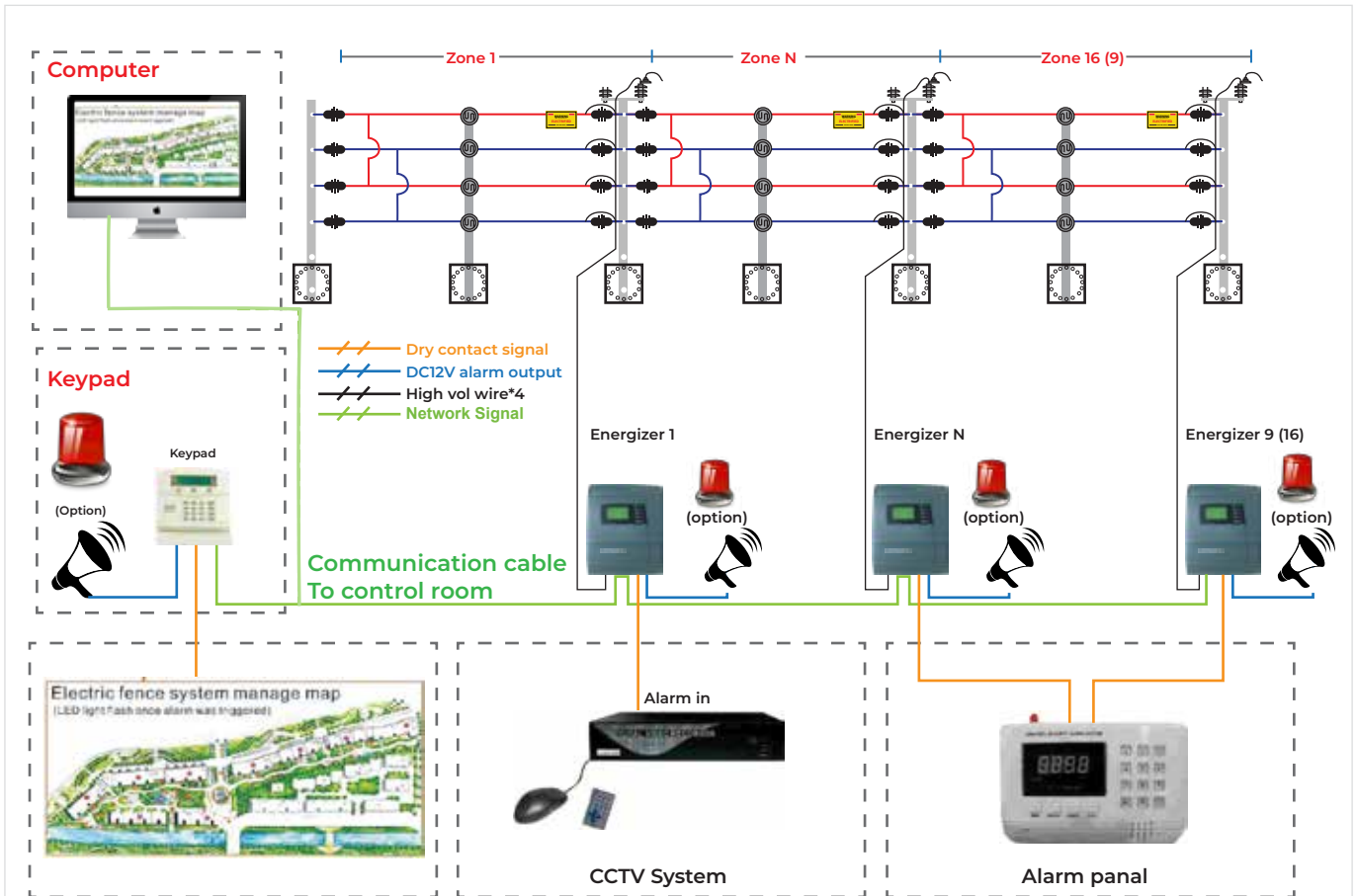

**Electric fence keypad controller**

Description:  
security system, controlling up to 16 zone at the same time. It can set up and cancel the defence zones immediately instead of setting up every energizer.

- Feature:
1. Password logging and password modifying function
  2. Control 1-16 zone of electric fence energizer by RS485 bus
  3. Alert zone numbers (ID) of electric energizer
  4. Alarming zones, types (short circuit and break), time record function
  5. DC12V Alarm signal output (LX-M8J only)



**Middle pull post**

Middle post, Made of Stainless Steel or Galvanized Steel, Which holds the spacing between two wires

1. Made of Stainless Steel or Galvanized Steel
2. Installed ever 3-5 meters
3. Anti-corrosive
4. Standard Lengths 1500\*200\*200\*2mm / 1250\*200\*200\*2mm

**Wire tensioner**

Electric fence wire tensioner, penetrated with the alloy wire, available in changing the tension of the alloy wire

1. Compound material
2. Installed on every alloy wire of terminal post
3. Anti corrosion and anti-oxidation

**Wire-wire linker**

Wire linker(wire connector), is used in connection between high voltage wire and alloy wire, fixed on the terminal posts

1. Aluminum made, anti-oxidation
2. Easy to install, light weight
3. Double threaded, prevent from loose of the wire

**Post fixation**

Fixation for electric fence security system middle posts, and middle pull posts, which can fix the posts on the floor and wall

1. Anti corrosion and high tensile
2. Stainless steel made
3. Fix the post and universal pedestal

**Lightning arrester**

Protecting the fence energizer from lightning strikes(thunder) on the fence perimeter.

This lightning arrester creates a path of least resistance, diverting lightning surges to the ground

Must separate with energizer grounding system with more than 10 meters distance

**Siren(speaker)**

Description: siren is being used very widely in perimeter security system especially in electric fence security system

It will release a loud noise to indicate intruders for admin to know where invasion happens

Working voltage: DC12V

**Siren (Audible and visual alarm)**

- High bright
- High transparency
- Fadeless
- Low noise

**Alloy wire( 1.8/2.5mm)**

Electric fence alloy wire, specially made wire for electric fence security system conducting electricity from the energizer to perimeter, The maximum tension is about 600N preventing continuous electric shock

1. Good conducting, low impedance
2. Zinc Coating <350g/m2
3. Resistance < 100 Ω/Km
4. Tensile Strength 150kg/m2
5. High elastic, oxidation resistant, anti corrosion
6. Three dimension : 1.8mm, 2.0mm,2.5mm

**Terminal post**

Terminal Post, Installed on the both ends also at the corner angles @120 degree of the electric fence, which holds the pressure and tension from the electric wire, can withstand up to 70 knots of wind pressure

1. Made of Stainless Steel or Galvanized Steel
2. Installed every 50-100 meters
3. Anti-corrosive
4. Standard Lengths 1500\*500\*500\*3mm / 1250\*400\*400\*2mm

**Terminal post insulator**

Terminal post insulator is widely installed on terminal posts, connecting terminal post and electric wire.

1. High voltage resistant of 15KV
2. UV Stabilized Plastic, anti-oxidation, corrosion resistance and anti-static
3. Made of ABS material, more durable
4. Working load <150kg

**Middle pull rod insulator**

This insulator is used to hold the wire and reduce the pressure of middle pull post or line posts. Using latch(pin) to fix the insulator

Easily installation

1. High voltage resistant>15KV
2. UV Stabilized Plastic, anti-oxidation, corrosion resistance and anti-static
3. Made of ABS material, more durable
4. Working load <50kg

**Terminal post fixing clip**

Discription: The fixing clip penetrated the terminal post insulator, and is fixed on terminal post or U groove, connecting the terminal post and insulator

Feature:

1. Made of stainless steel, more durable
2. Rust proof

**Voltmeter**

Easily detect the voltage on electric fence or voltage between earth and electric fence, and show the value on the LCD screen.

1. Voltage range detected from 1000 to 10,000 voltage
2. Low consumption, power saved
3. Automatic off/on, Replaceable 9v battery

**Luminated Warning sign**

Warning sign should be hang in the electric fence to indicate there is electric shock on the fence and give a psychological barrier to intruders. Luminated warning sign, can be seen during the night with double printed black letters.

1. Large black letters onboth sides
2. Indicate electric shock with picture and words
3. Installed every 10 meters on the fence
4. Luminate 10 hours of absorbing light for 10 mintes

**Energizer protective Housing**

435x350x150mm fan or temperature switch optional, Made of metal

**High voltage cable**

Double insulated high voltage cable is used to connect the energizer and terminal post to conduct the electric shock

1. Double insulated , resistant of 20KV high voltage plus
- 2.2.5 square millimeter aluminum conductor

